

STAYPLATES

Stayplates ensure the blocks in a HTS rectangular system (tolerant and blank ones) are fixed in position after compression. A stayplate should be placed above each complete row of insert/filler blocks. However, never on the last top row (underneath the compression plate) and never below the last bottom row of blocks.



- Available in AISI 304 stainless steel. AISI 316 and other materials under request.
- High pressure stayplates (931P) are to be used in applications where the pressure requirement is greater than 3.5 bar.
- Ex available under request.

HTS standard Stayplate

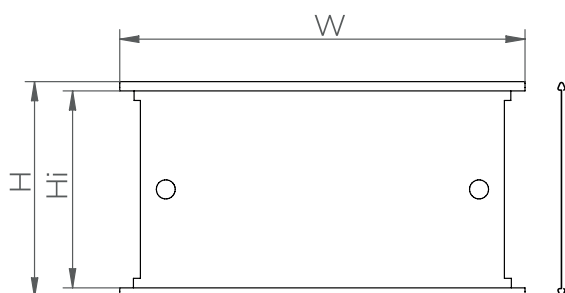

HTS high pressure Stayplate

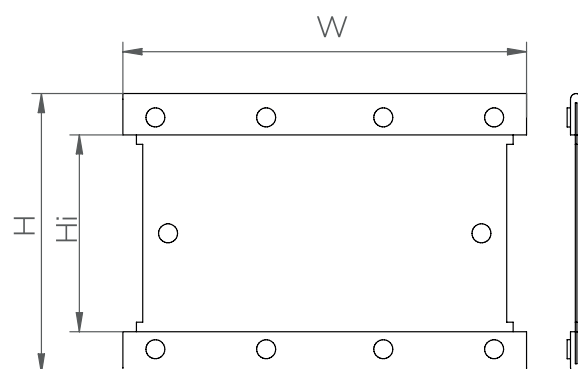

DESCRIPTION	W (mm)	H (mm)	Hi (mm)
Stayplate 931 60mm	68	68	62
Stayplate 931 120mm	128	68	62
High Pressure Stayplate 931/P 120mm	128	88	62
Stayplate 931 180mm	188	68	62
Stayplate 931 240mm	248	68	62
Stayplate 931 360mm	368	68	62