

# H-HC Frame

The H-HC frame is manufactured with flange. This flange can be placed centrally in the frame or offset on one side. Available in two different widths; 60 and 120 mm wide (internal).

## CHARACTERISTICS

- To be installed (bolted) inside or outside the panels and cabinets.
- To be sealed with HTS standard HF blocks and compression system, stayplates and lubricant.
- Materials: Stainless steel, mild steel.
- Compression tool required for installation.
- Customizable flange and frame sizes (the latter according to our standard sizes).
- Ex available under request.

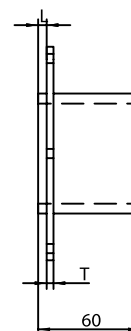
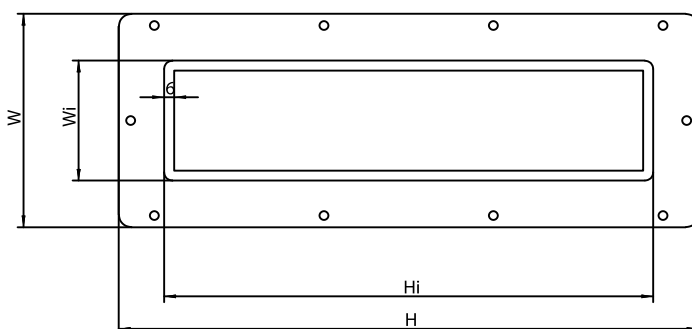

| H-HC M+P | A   | B     | C     |
|----------|-----|-------|-------|
| H-HC 1+1 | 60  | 101   | 101   |
| H-HC 2+2 | 120 | 101   | 101   |
| H-HC 3+1 | 60  | 159,5 | 101   |
| H-HC 3+3 | 60  | 159,5 | 159,5 |
| H-HC 4+2 | 120 | 159,5 | 101   |
| H-HC 4+4 | 120 | 159,5 | 159,5 |
| H-HC 5+1 | 60  | 218   | 101   |
| H-HC 5+3 | 60  | 218   | 159,5 |
| H-HC 5+5 | 60  | 218   | 218   |
| H-HC 6+2 | 120 | 218   | 101   |
| H-HC 6+4 | 120 | 218   | 159,5 |
| H-HC 6+6 | 120 | 218   | 218   |
| H-HC 7+1 | 60  | 276,5 | 101   |
| H-HC 7+3 | 60  | 276,5 | 159,5 |
| H-HC 7+5 | 60  | 276,5 | 218   |
| H-HC 7+7 | 60  | 276,5 | 276,5 |
| H-HC 8+2 | 120 | 276,5 | 101   |
| H-HC 8+4 | 120 | 276,5 | 159,5 |
| H-HC 8+6 | 120 | 276,5 | 218   |
| H-HC 8+8 | 120 | 276,5 | 276,5 |

| H-HC M | A   | B     |
|--------|-----|-------|
| H-HC 1 | 60  | 101   |
| H-HC 2 | 120 | 101   |
| H-HC 3 | 60  | 159,5 |
| H-HC 4 | 120 | 159,5 |
| H-HC 5 | 60  | 218   |
| H-HC 6 | 120 | 218   |
| H-HC 7 | 60  | 276,5 |
| H-HC 8 | 120 | 276,5 |

| Installation References |      |
|-------------------------|------|
|                         | page |
| See assembly parts      | 69   |
| See accessories         | 79   |
| See instalation guide   | 128  |