

# CBP CASTING SLEEVE

HTS CBP Sleeves are designed to be casted in concrete walls creating a uniform round opening that can later be used to install and seal cables or pipes using HTS Blind Plugs, HRST and HBRT Sealing Systems. Ensuring a watertight seal in the connection with the concrete.

## CHARACTERISTICS

- Compatible with HTS HBRST, HBRT and HTS Blind Plugs sealing systems.
- Available in multitude of diameters: Ø100mm, Ø150mm, Ø200mm.
- Offered in multiple sleeve depths: 500mm to 100mm.
- Depths can be adjusted on-site by cutting to the required length. With grooves for cutting to length at the construction site.
- Material: ABS.

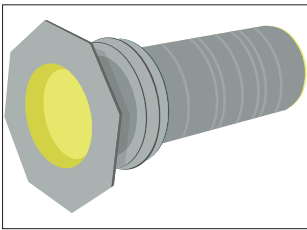

Supplied with removable end caps on both sides.

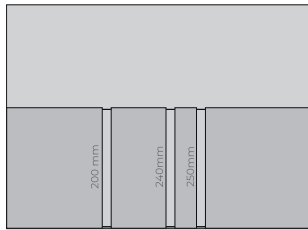

Depths can be adjusted on-site by cuttend to the required length. With grooves for cutting to length at the construction site.

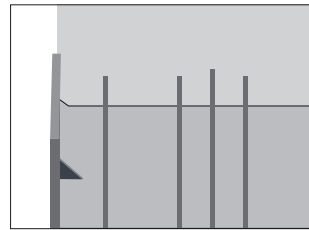

With waterstops for watertight.

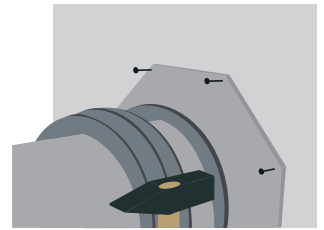

Tower Flange for fastening.

## TYPICAL USE CASES

- Electrical and communication cable infrastructure.
- Industrial and civil ducting systems.
- Pre-installation sealing for underground or wall-mounted conduits.

Ø	L	X
100	100-500	220
150	100-500	270
200	100-500	320

